

| ENCODER    |             |
|------------|-------------|
| VOLTAGE    | +5 VDC ±5%  |
| CURRENT    | max. 200 mA |
| FREQUENCY  | 0 - 125 kHz |
| TEMP.      | 20 - 100 °C |
| RESOLUTION | 1000        |

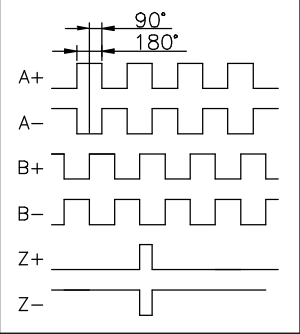

| Motor Specification |                        |
|---------------------|------------------------|
| Resistance          | 0.11 Ohm ±10%          |
| Inductance          | 0.13 mH ±20%           |
| Voltage             | 24 VDC                 |
| Rated Power         | 235 W                  |
| Rated Speed         | 3000 rpm               |
| Rated Current       | 13 A                   |
| Rated Torque        | 0.75 Nm                |
| Peak Current        | 39 A                   |
| Peak Torque         | 2.25 Nm                |
| Ke (RMS)            | 4.25 V/Krpm            |
| Rotor Inertia       | 0.72 kgcm <sup>2</sup> |
| Number of Poles     | 8                      |
| Weight              | 1.7 kg                 |

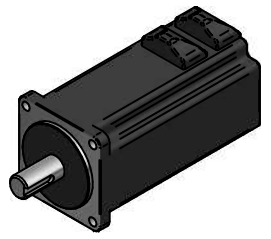
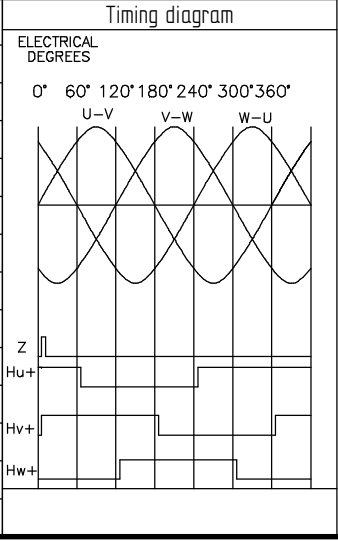

Encoder connector - D-SUB HD 15 PIN

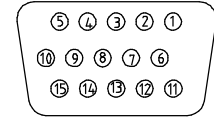

Motor phases

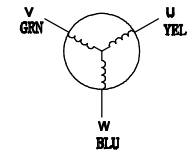

| ENCODER CONNECTIONS |         |        |
|---------------------|---------|--------|
| Pin                 | Color   | Signal |
| 1                   | red     | +5V    |
| 2                   | blk     | GND    |
| 3                   | -       | -      |
| 4                   | yel     | U+     |
| 5                   | yel/blk | U-     |
| 6                   | org     | Z+     |
| 7                   | gry     | B+     |
| 8                   | brn     | A+     |
| 9                   | whi     | W+     |
| 10                  | grn     | V+     |
| 11                  | org/blk | Z-     |
| 12                  | gry/blk | B-     |
| 13                  | brn/blk | A-     |
| 14                  | wht/blk | W-     |
| 15                  | grn/blk | V-     |

| MOTOR CONNECTIONS |       |        |
|-------------------|-------|--------|
| Pin               | Color | Signal |
| 1                 | yel   | U      |
| 2                 | grn   | V      |
| 3                 | blu   | W      |

PSM60-2330B8E1ND

**...::POSITEC**