

# PM10LWS

- MOTOR Permanent magnet DC motor
- PROTECTION Totally enclosed (IP54)
- GEARBOX Worm spur (LWS)
- MOTOR POWER 23 - 100 Watts
- SPEED 0.4 - 80 rpm
- VOLTAGE 12V - 220V DC available range
- WEIGHT 5.03 kg
- RADIAL LOAD 446 N
- AXIAL LOAD 226 N
- SHAFT TYPE Single ended or double ended shaft as standard; 17mm diameter shaft available with ratios 115:1 and 56:1
- EXTRAS Gearbox available without feet; unit can be mounted on gearbox spigot; for further options see page 36



See page 158 to specify shaft and gearbox position

Motor Power Cont (W)	23	30	45	60	TORQUE (Nm)			
Motor Power 1 Hour (W)	28	38	55	75	CONTINUOUS	1 HOUR	15 MINUTE	
Motor Power 15 Min (W)	35	50	70	100				
Ratio Worm	Ratio Spur	MOTOR SPEED (rpm)				CONTINUOUS	1 HOUR	15 MINUTE
		1500	2000	3000	4000			
		OUTPUT SPEED (rpm)						
30	115	0.4	0.6	0.9	1.2	100	100	100
16 1/2	115	0.8	1.1	1.6	2.1	100	100	100
8 1/3	115	1.6	2.1	3.1	4	84	100	100
7 1/4	115	1.8	2.4	3.6	5	75	92	100
12 1/2	56	2.1	2.9	4.3	6	55	67	86
10 1/3	56	2.6	3.5	5.2	7	48	59	75
9 1/3	56	2.9	3.8	5.7	8	44	54	69
8 1/3	56	3.2	4.3	6.4	9	41	50	63
7 1/4	56	3.7	4.9	7.4	10	37	45	57
6 1/4	56	4.3	5.7	8.6	11	33	40	51
13 1/2	25	4.4	5.9	9	12	26	32	40
12 1/2	25	4.8	6.4	10	13	25	30	38
10 1/3	25	5.8	8	12	15	21	26	33
9 1/3	25	6.4	9	13	17	20	24	31
8 1/3	25	7	10	14	19	18	22	28
6 1/4	25	10	13	19	26	15	18	23
16 1/2	6	15	20	30	40	7	9	11
13 1/2	6	19	25	37	49	6	8	10
11 1/3	6	22	29	44	59	5	7	9
9 1/3	6	27	36	54	71	5	6	7
8 1/3	6	30	40	60	80	4	5	7

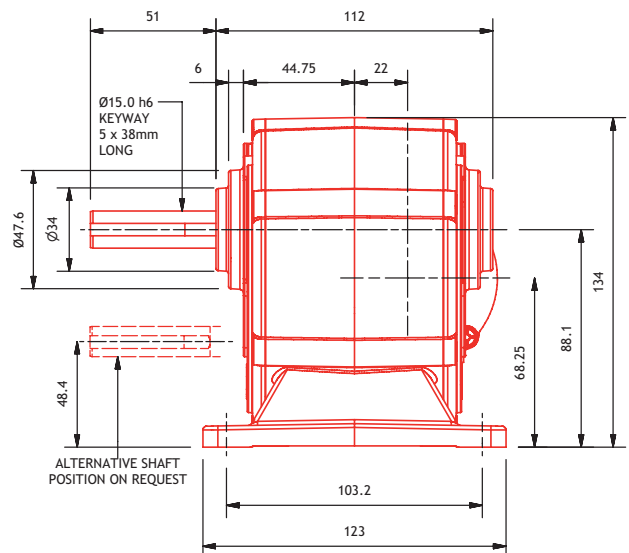
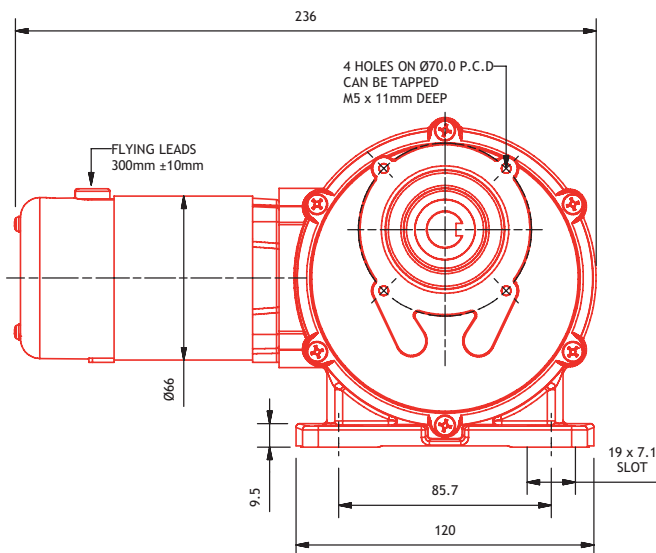

worm spur