

Technical Data

Number of poles	6	
Rated Voltage	48 V	
Rated Power	1000 W	
Rated Torque	3.18 Nm	
Rated Speed	3000 rpm	
Rated Current (RMS)	32 A	
Maximum Torque	9.54 Nm	
Maximum Current (RMS)	81 A	
Standstill Torque	3.50 Nm	
Standstill Current	35.2 A	
Resistance line-line	0,034 Ohm $\pm 10\%$	
Inductance line-line	TBD	
Electrical time constant	TBD	
Mechanical time constant	TBD	
Voltage constant	6.4 V/krpm	
Torque constant	0.106 Nm/A	
Rotor moment of inertia	1.9 kgcm ²	
Max. voltage rising	8 kV/ μ s	
Isulation class	F	
Max. radial force	335 N	
Max. axial force	167.5 N	
Weight	3,9 kg	
Feedback device	Incremental encoder	
	2500p/ rev	
	TS6014N115	
Cooling method	Totally enclosed non-ventilated	
Protection level	IP65, shaft sealing IP54	
Environmental conditions	Temperature	-20°C to 40°C
	Humidity	Below 90%
	Environment	Far away active gas, combustible gas, oil drop, osh.
	Installation altitude	UP TO 1000m:rated power above 1000m:15% power decreasing per 100m,max.400m
Rating Conditions	Mounting	Aluminium flange 255x255x6mm
	Temperature	60K housing temperature rising at 40°C ambient

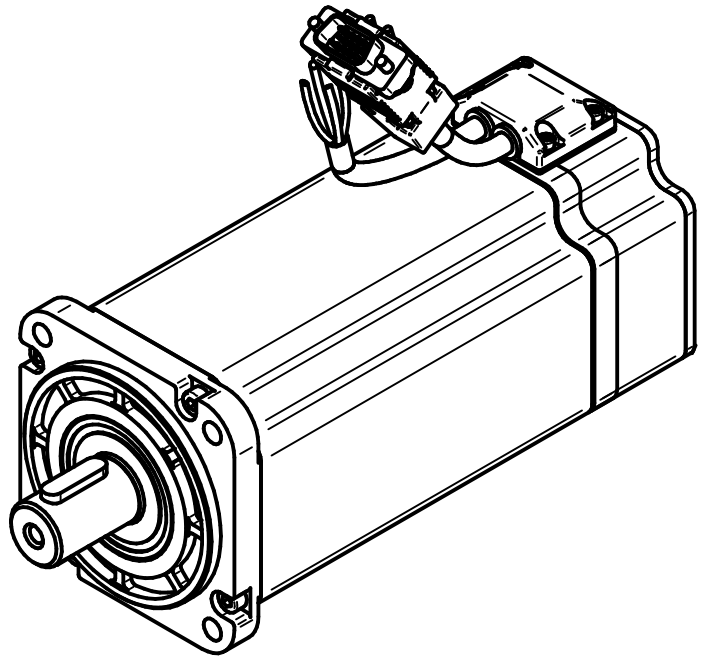

Performance Curve

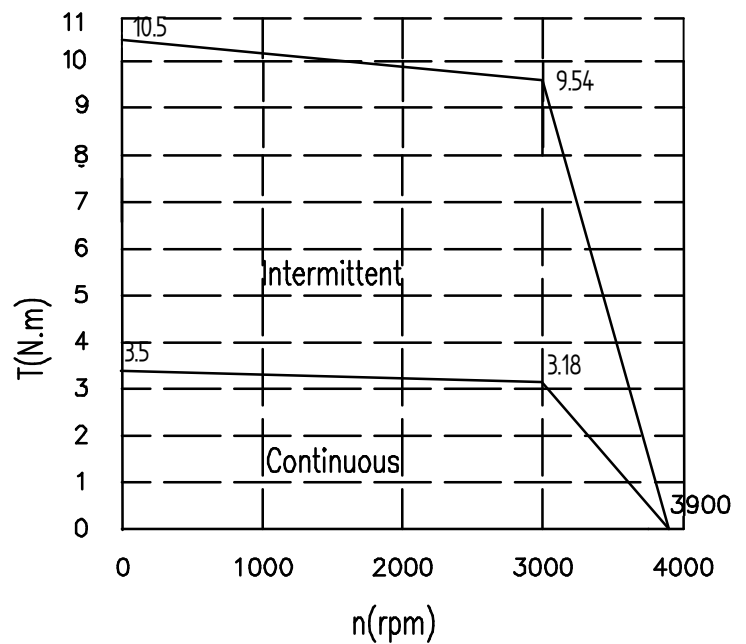

PSM80-10030A6E2NC1-34

Ultra
Robotics

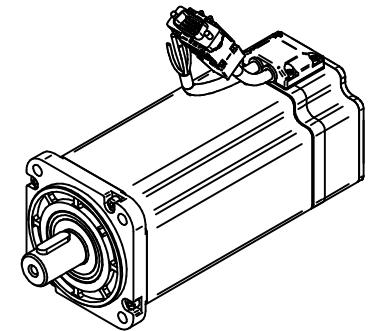
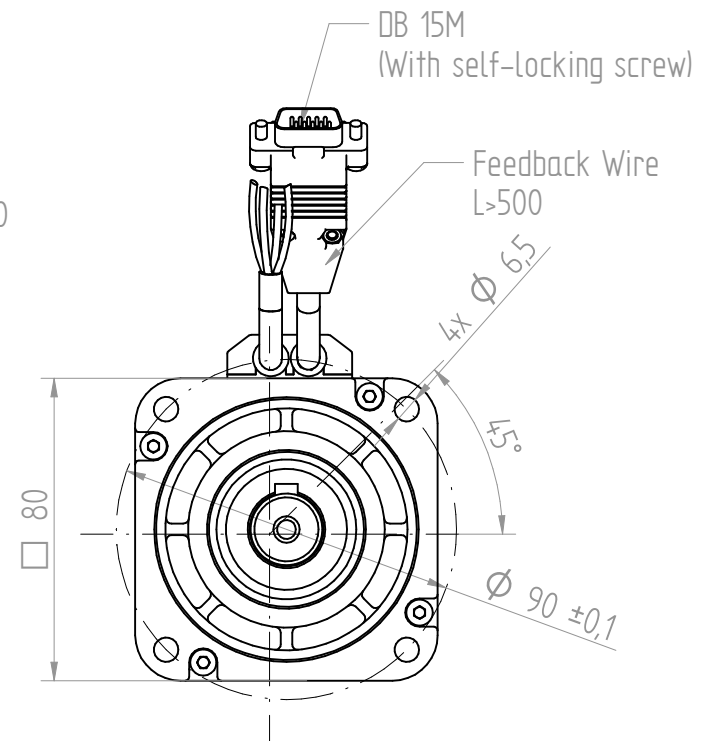
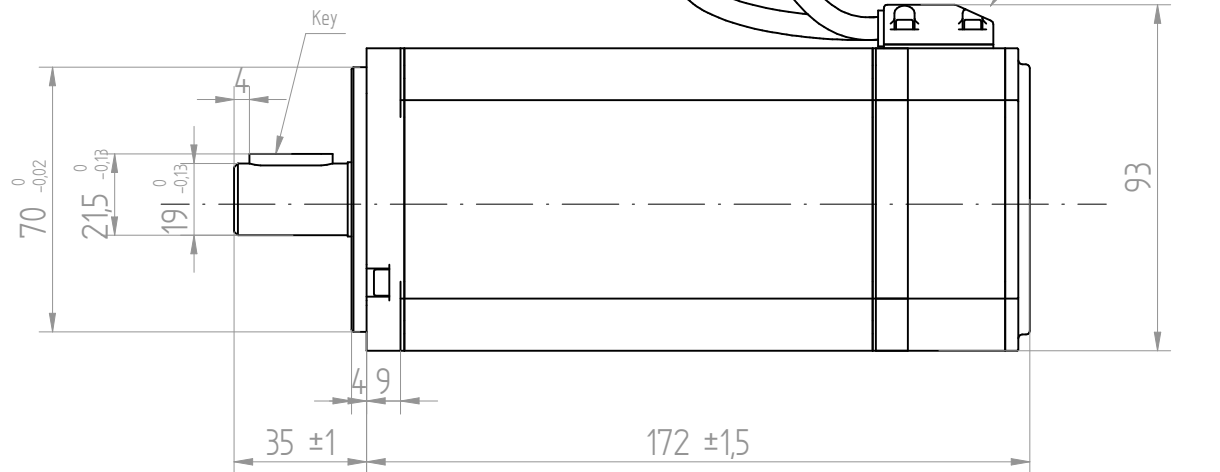
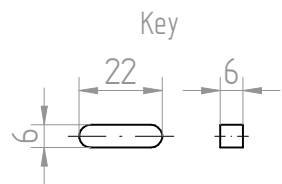

ENCODER CONNECTIONS

Pin	Color	Signal
1	red	+5V
2	NC	NC
3	black	GND
4	brn/blk	Z
5	yellow	/Z
6	yellow/black	/U
7	brow/black	/V
8	white/black	/W
9	blue/black	/A
10	green/black	/B
11	brown	U
12	gray	V
13	white	W
14	blue	A
15	green	B

Encoder connector - D-SUB HD 15 PIN

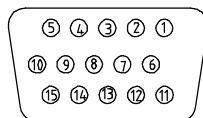

POWER WIRE CONNECTIONS

Pin	Color	Signal
1	Yellow	U
2	Red	V
3	Black	W

PSM80-10030A6E2NC1-34

**Ultra
Robotics**